



FORTUNE CREEK LODGE - PLAN M7800A3FA-0

Total Area: 8450 sq. ft.
Garage Area: 1575 sq. ft.
Garage Area: 1575 sq. ft.
Garage Size: 3
Stories: 2
Bedrooms: 6
Full Baths: 5
Half Baths: 2
Width: 154'-0"
Depth: 112'-0"
Height: 33'-0"
Foundation: Crawl Space



Plan is not available to be built in Kittitas County in Washington State.

FORTUNE CREEK LODGE - PLAN M7800A3FA-0

MAIN FLOOR

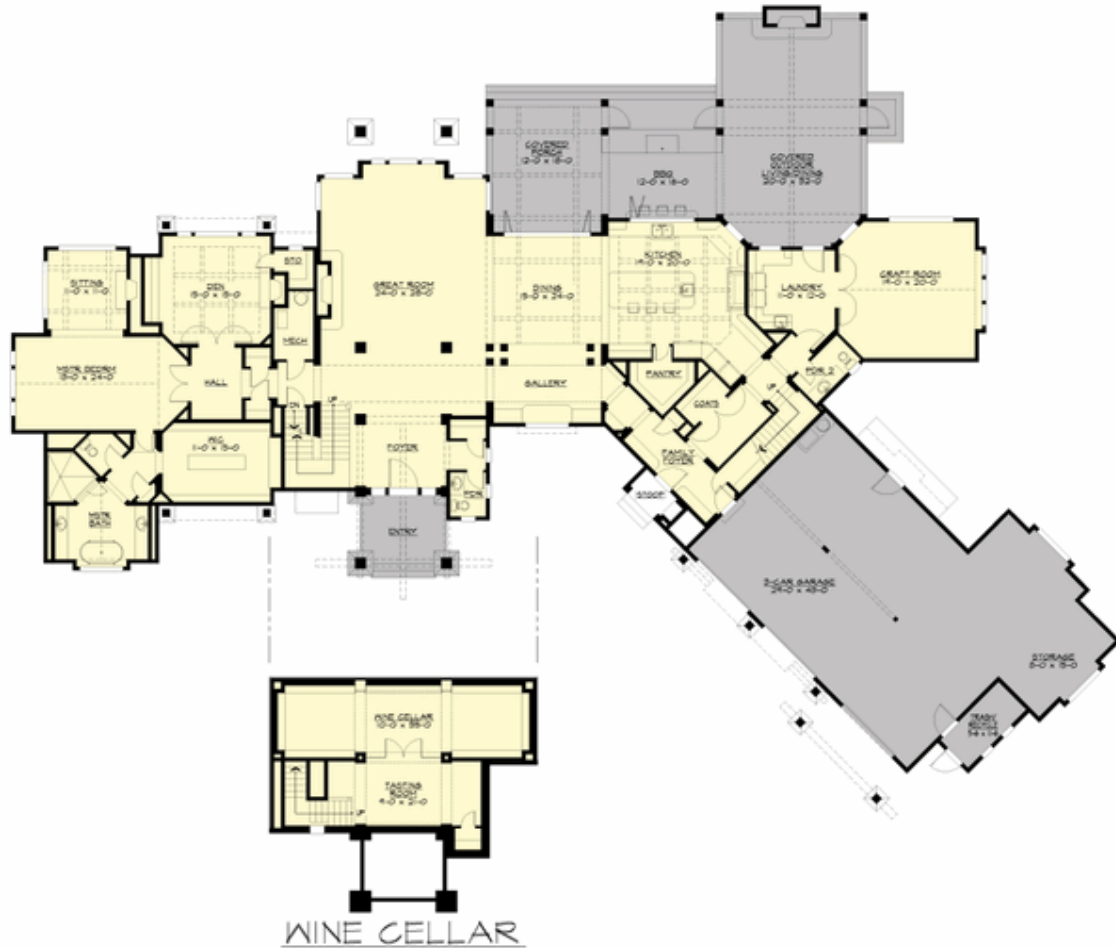

FORTUNE CREEK LODGE - PLAN M7800A3FA-0

UPPER FLOOR





FORTUNE CREEK LODGE - PLAN M7800A3FA-0

PLAN DETAILS

Area Summary

Total Area:	8450 sq. ft.
Main Floor:	4468 sq. ft.
Upper Floor:	3332 sq. ft.
Lower Floor:	650 sq. ft.
Garage Floor:	1575 sq. ft.

General Information

Stories:	2
Width:	154'-0"
Depth:	112'-0"
Height:	33'-0"

Architectural Style

Craftsman
Lodge
Mountain

Number of Rooms

Bedrooms:	6
Full Baths:	5
Half Baths:	2

Garage

Garage Size:	3
Garage Door Location:	Front
Garage Type:	Angled

Roof Pitches

Primary:	8:12
Secondary:	4:12

Wall Heights

Main:	10'-0"
Upper:	9'-0"
3rd Floor:	0'-0"
Lower:	9'-0"

Foundation Type

Crawl Space

Roof Framing

Combination

Floor Load

Live (lbs):	40 PSF
Dead (lbs):	10 PSF

Roof Load

Live (lbs):	131 PSF
Dead (lbs):	15 PSF
Wind:	85 MPH

Design Features

- Bonus Space @ Upper Floor
- Den/Office
- Great Room
- Laundry Room @ Main Floor
- Luxury Plan
- Master Bedroom @ Main Floor Rear
- Rear Porch
- Suncadia Collection
- Wide Lot