



LOVETT - PLAN M5062A3FD-0

Total Area: 5062 sq. ft.
Garage Area: 946 sq. ft.
Garage Area: 946 sq. ft.
Garage Size: 3
Stories: 2
Bedrooms: 3
Full Baths: 4
Half Baths: 1
Width: 143'-0"
Depth: 53'-6"
Height: 29'-0"
Foundation: Crawl Space



[illegible]

LOVETT - PLAN M5062A3FD-0

UPPER FLOOR



LOVETT - PLAN M5062A3FD-0

THIRD FLOOR

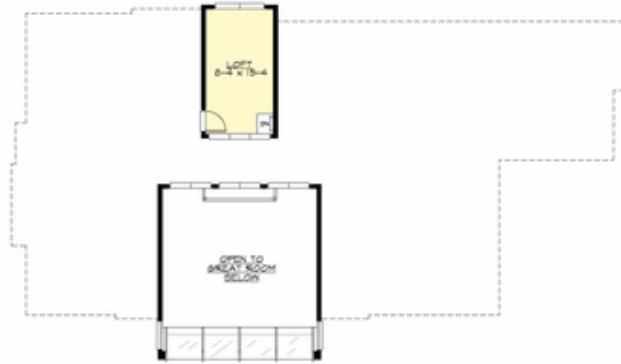



LOVETT - PLAN M5062A3FD-0

PLAN DETAILS

Area Summary

Total Area:	5062 sq. ft.
Main Floor:	2879 sq. ft.
Upper Floor:	2031 sq. ft.
3rd Floor:	152 sq. ft.
Garage Floor:	946 sq. ft.

General Information

Stories:	2
Width:	143'-0"
Depth:	53'-6"
Height:	29'-0"

Architectural Style

Contemporary
Modern
Prairie

Number of Rooms

Bedrooms:	3
Full Baths:	4
Half Baths:	1

Garage

Garage Size:	3
Garage Door Location:	Front
Garage Type:	Detached

Roof Pitches

Primary:	0:12
Secondary:	2:12

Wall Heights

Main:	10'-0"
Upper:	8'-0"
3rd Floor:	6'-0"
Lower:	0'-0"

Foundation Type

Crawl Space

Roof Framing

Stick

Floor Load

Live (lbs):	40 PSF
Dead (lbs):	10 PSF

Roof Load

Live (lbs):	25 PSF
Dead (lbs):	15 PSF
Wind:	85 MPH

Design Features

- Bonus Space @ Main Floor
- Den/Office
- Front Porch
- Great Room
- Laundry Room @ Main & Upper Floor
- Luxury Plan
- Master Bedroom @ Upper Floor Front
- View Lot - Front
- Wide Lot