

MARYSVILLE - PLAN M5275A1FU2STU-0

Total Area: 5275 sq. ft.
Garage Area: 1665 sq. ft.
Garage Area: 1665 sq. ft.
Garage Size: 3
Stories: 3
Bedrooms: 5
Full Baths: 3
Width: 68'-0"
Depth: 64'-0"
Height: 33'-6"
Foundation: Crawl Space



MARYSVILLE - PLAN M5275A1FU2STU-0

MAIN FLOOR

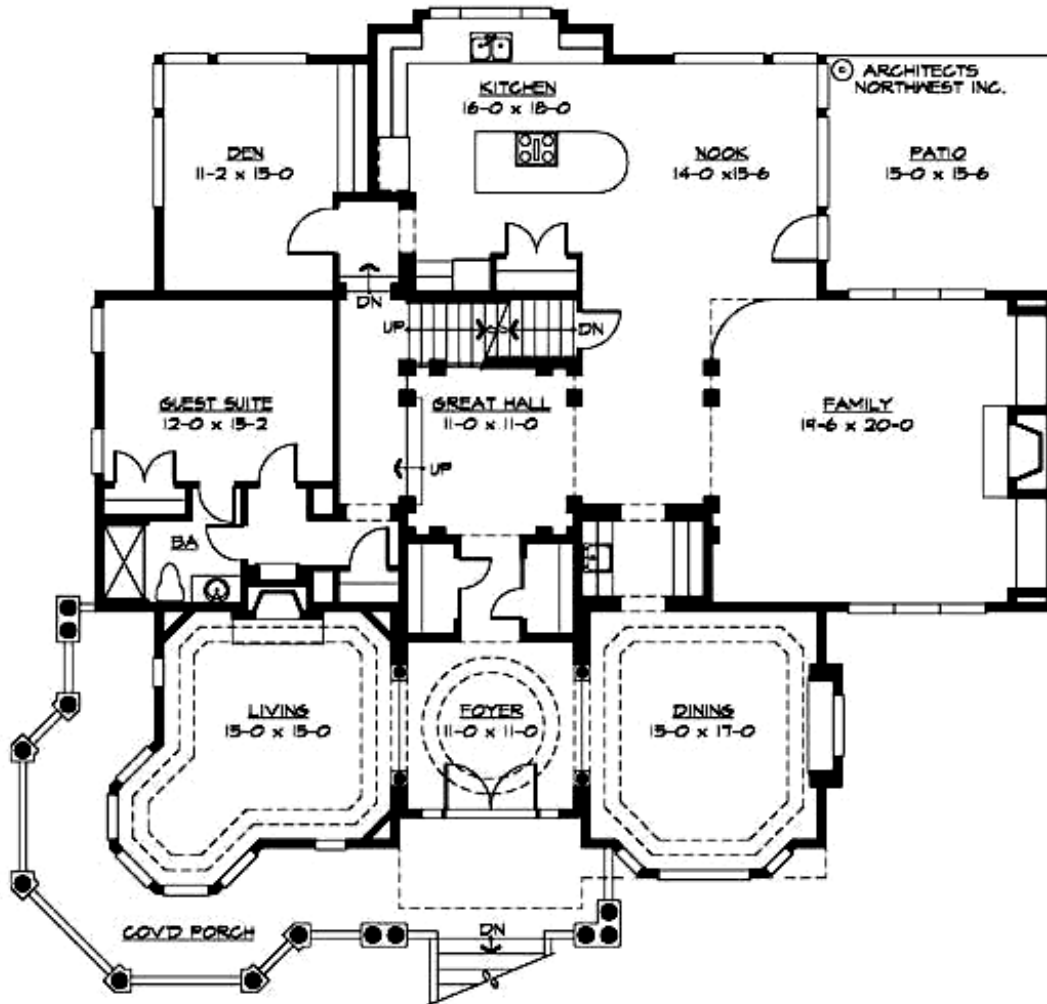

MARYSVILLE - PLAN M5275A1FU2STU-0

LOWER FLOOR

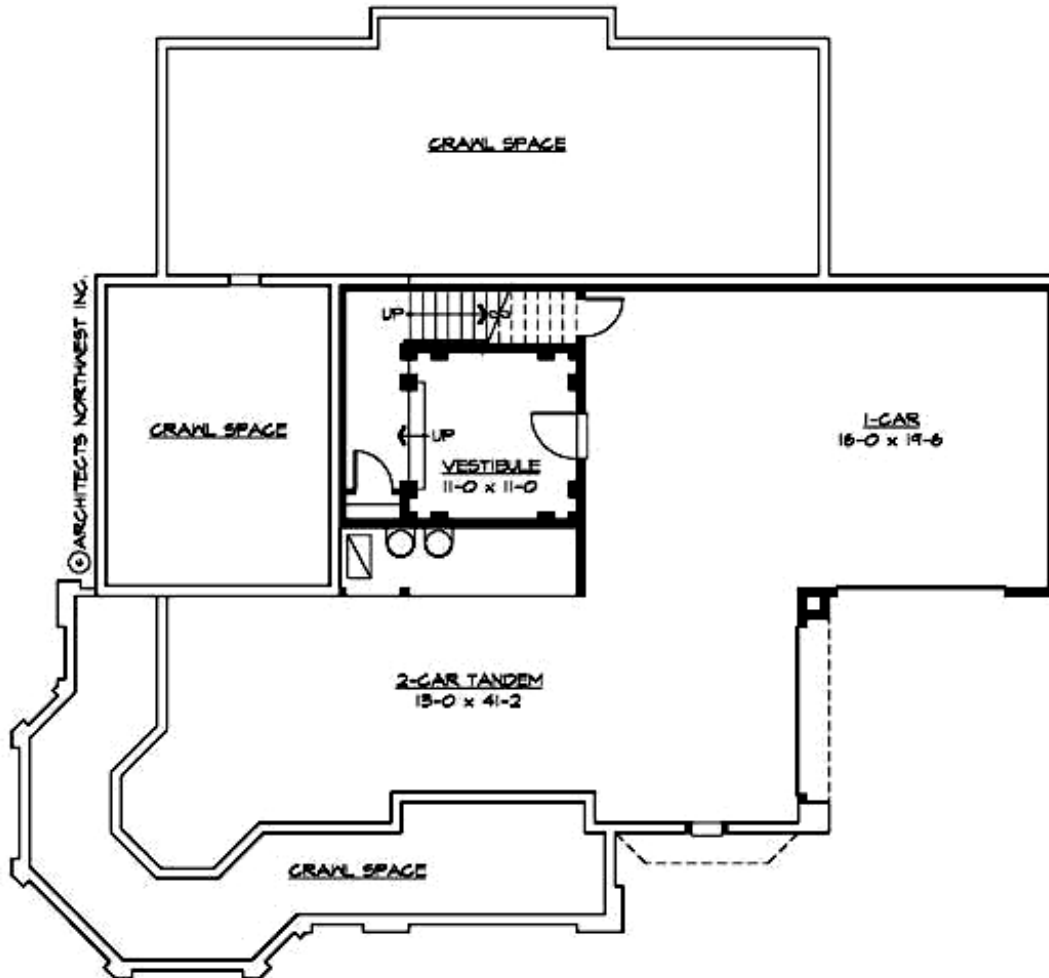

MARYSVILLE - PLAN M5275A1FU2STU-0

THIRD FLOOR

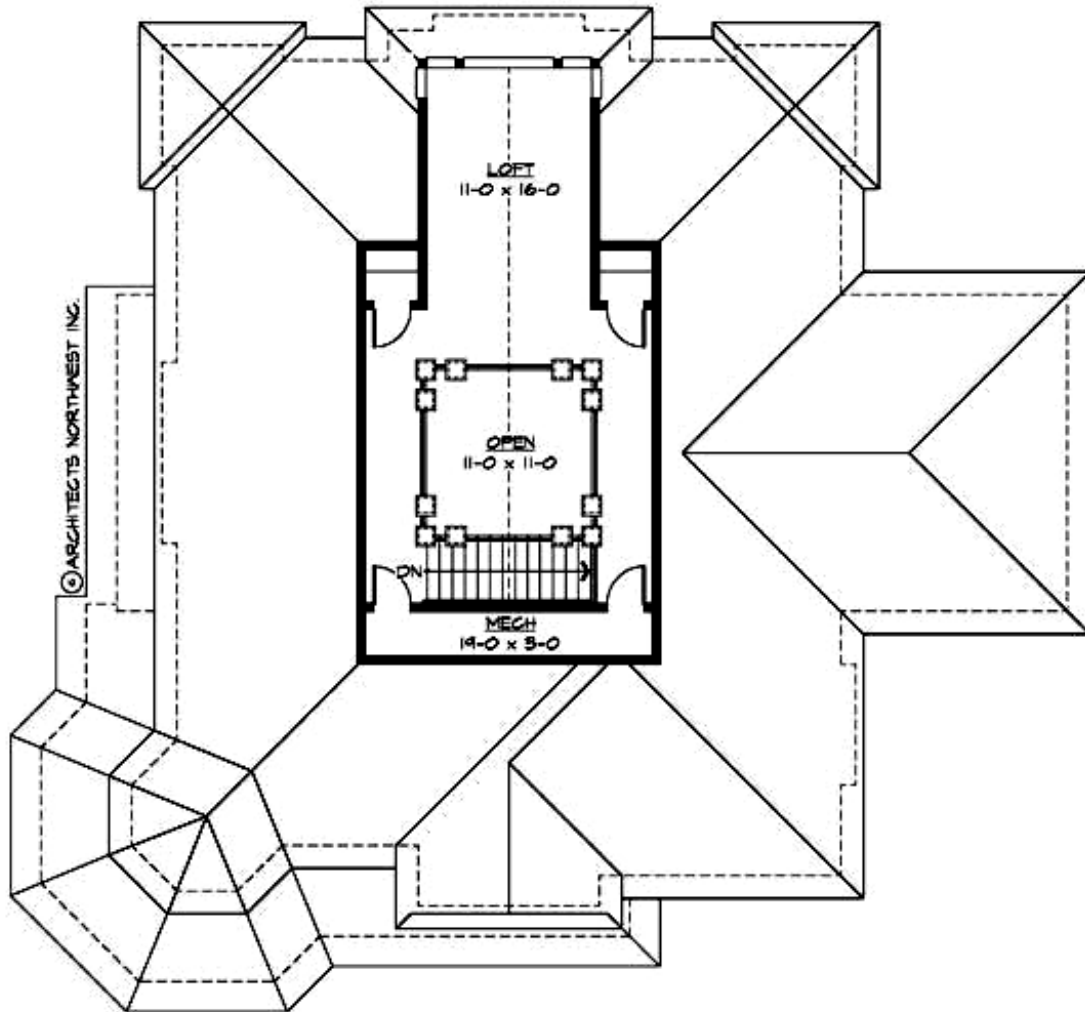



MARYSVILLE - PLAN M5275A1FU2STU-0

PLAN DETAILS

Area Summary

Total Area:	5275 sq. ft.
Main Floor:	2700 sq. ft.
Upper Floor:	2100 sq. ft.
3rd Floor:	475 sq. ft.
Garage Floor:	1665 sq. ft.

General Information

Stories:	3
Width:	68'-0"
Depth:	64'-0"
Height:	33'-6"

Architectural Style

Farmhouse
Shingle
Traditional

Number of Rooms

Bedrooms:	5
Full Baths:	3

Garage

Garage Size:	3
Garage Door Location:	Side
Garage Type:	Under

Roof Pitches

Primary:	8:12
Secondary:	4:12

Wall Heights

Main:	9'-0"
Upper:	8'-0"
3rd Floor:	0'-0"
Lower:	9'-0"

Foundation Type

Crawl Space

Roof Framing

Trusses

Floor Load

Live (lbs):	40 PSF
Dead (lbs):	10 PSF

Roof Load

Live (lbs):	25 PSF
Dead (lbs):	15 PSF
Wind:	85 MPH

Design Features

- Bonus Space @ Upper Floor
- Den/Office
- Laundry Room @ Upper Floor
- Living & Family Room
- Master Bedroom @ Upper Floor Front
- Wrap-Around Porch