



CICERO CREEK - PLAN R3695A2S-1DBR

Total Area: 3333 sq. ft.
Garage Area: 682 sq. ft.
Garage Area: 682 sq. ft.
Garage Size: 2
Stories: 2
Bedrooms: 4
Full Baths: 3
Half Baths: 1
Width: 73'-6"
Depth: 79'-6"
Height: 19'-6"
Foundation: Daylight Basement



CICERO CREEK - PLAN R3695A2S-1DBR

MAIN FLOOR



CICERO CREEK - PLAN R3695A2S-1DBR

LOWER FLOOR

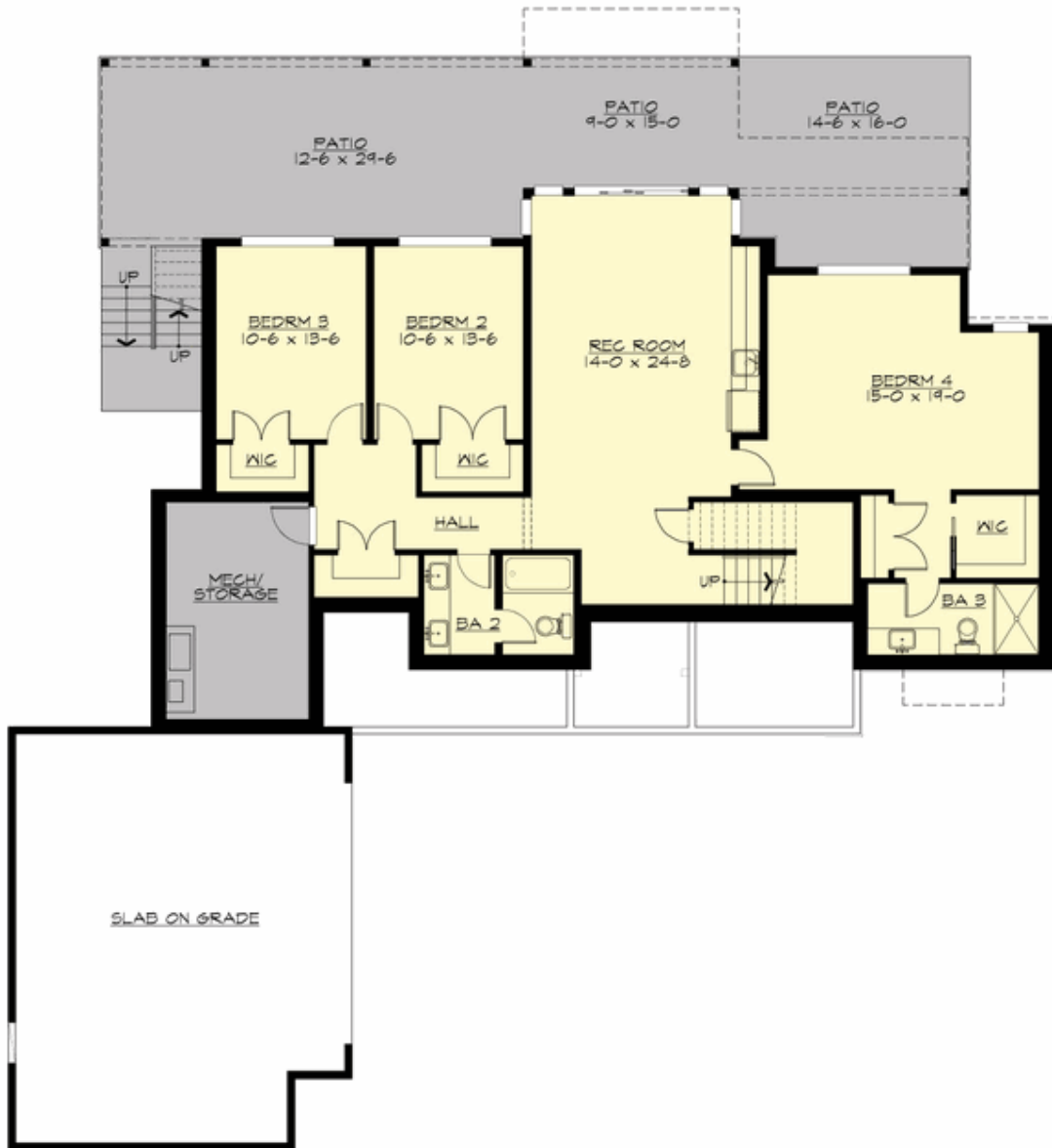



CICERO CREEK - PLAN R3695A2S-1DBR

PLAN DETAILS

Area Summary

Total Area: 3333 sq. ft.
Main Floor: 1799 sq. ft.
Lower Floor: 1534 sq. ft.
Garage Floor: 682 sq. ft.

General Information

Stories: 2
Width: 73'-6"
Depth: 79'-6"
Height: 19'-6"

Architectural Style

Contemporary
Modern
Prarie

Number of Rooms

Bedrooms: 4
Full Baths: 3
Half Baths: 1

Garage

Garage Size: 2
Garage Door Location: Side

Roof Pitches

Primary: 3:12

Wall Heights

Main: 10'-0"
Lower: 9'-0"

Foundation Type

Daylight Basement

Roof Framing

Combination

Floor Load

Live (lbs): 40 PSF
Dead (lbs): 10 PSF

Roof Load

Live (lbs): 25 PSF
Dead (lbs): 15 PSF
Wind: 85 MPH

Design Features

- Bonus Space @ Lower Floor
- Den/Office
- Front and Rear Porch
- Great Room
- Laundry Room @ Main Floor
- Master Bedroom @ Main Floor Rear
- View Lot - Rear