



FEATHERDALE FALLS - PLAN R3270A3FA-4

Total Area: 4550 sq. ft.
Garage Area: 1277 sq. ft.
Garage Size: 3
Stories: 2
Bedrooms: 4
Full Baths: 3
Half Baths: 1
Width: 132'-0"
Depth: 85'-0"
Height: 24'-0"
Foundation: Crawl Space



This detailed floor plan shows a 3-car garage house with a central island. The layout includes:

- Garage:** 3-CAR GARAGE (37'-2x37'-2) on the left side.
- Living Areas:** VAULTED OUTDOOR LIVING (17'-0x18'-0), VAULTED MSTR BEDRM (17'-2x17'-8), VAULTED GREAT RM (20'-6x21'-6), VAULTED FOYER (9'-6x12'-0), and VAULTED COVD ENTRY (9'-0x12'-0).
- Kitchen & Dining:** KITCHEN (15'-6x19'-8), DINING (11'-0x14'-6), and NOOK (15'-0x23'-6).
- Bedrooms:** MSTR BEDRM (17'-2x17'-8), BEDRM 2 (11'-4x13'-6), BEDRM 3 (11'-6x13'-4), and BEDRM 4 (11'-6x13'-0).
- Bathrooms:** MSTR BATH, BA2, and BAS.
- Other Rooms:** HALL, LAUNDRY (2'-0x12'-0), DEN (11'-6x13'-2), and various closets (CL, LIN, NIG).
- Outdoor Features:** COVD PATIO (10'-0x18'-0).

The plan also shows a central island with a sink and a large vaulted great room with a fireplace. The overall design is modern and functional, with a focus on open living spaces and a large garage.

FEATHERDALE FALLS - PLAN R3270A3FA-4

UPPER FLOOR

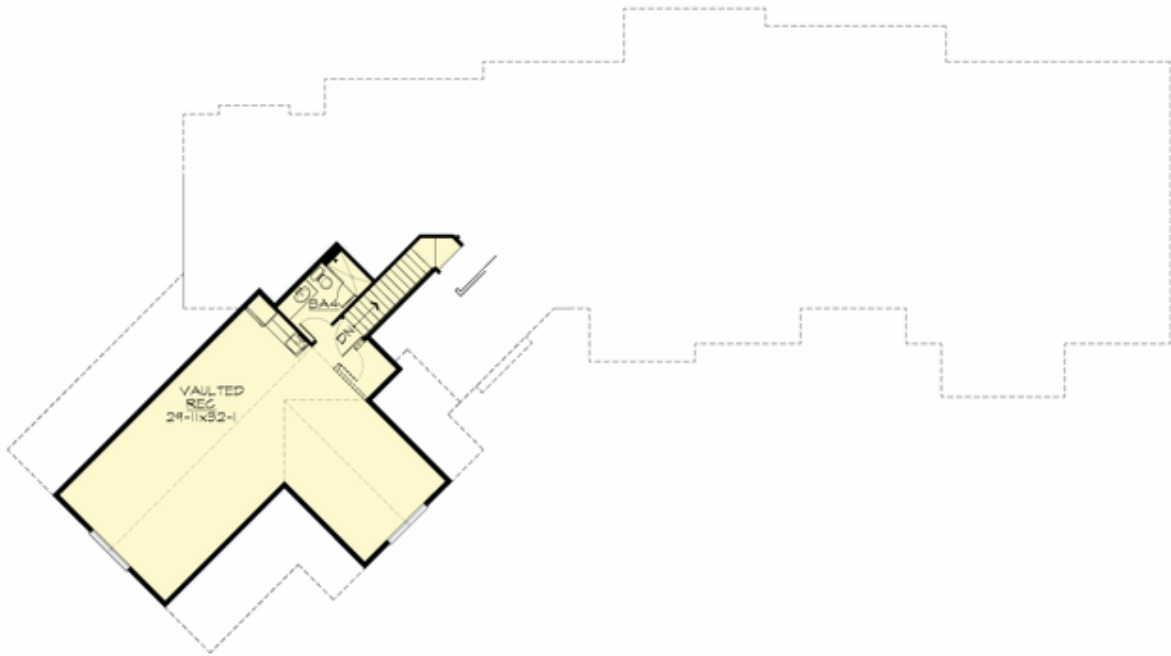



FEATHERDALE FALLS - PLAN R3270A3FA-4

PLAN DETAILS

Area Summary

Total Area: 4550 sq. ft.
Main Floor: 3654 sq. ft.
Upper Floor: 886 sq. ft.
Garage Floor: 1277 sq. ft.

General Information

Stories: 2
Width: 132'-0"
Depth: 85'-0"
Height: 24'-0"

Architectural Style

Craftsman
Lodge
Ranch

Number of Rooms

Bedrooms: 4
Full Baths: 3
Half Baths: 1

Garage

Garage Size: 3
Garage Door Location: Front
Garage Type: Angled

Roof Pitches

Primary: 8:12

Wall Heights

Main: 10'-0"
Upper: 8'-0"

Foundation Type

Crawl Space

Roof Framing

Trusses

Floor Load

Live (lbs): 40 PSF
Dead (lbs): 10 PSF

Roof Load

Live (lbs): 25 PSF
Dead (lbs): 15 PSF
Wind: 85 MPH

Design Features

- Best Selling Plan
- Bonus Space @ Upper Floor
- Den/Office
- Great Room
- Laundry Room @ Main Floor
- Master Bedroom @ Main Floor Rear
- Rear Porch
- View Lot - Rear
- Wide Lot