



## LOVETT - PLAN M5062A3FD-0

Total Area: 5062 sq. ft.  
Garage Area: 946 sq. ft.  
Garage Area: 946 sq. ft.  
Garage Size: 3  
Stories: 2  
Bedrooms: 3  
Full Baths: 4  
Half Baths: 1  
Width: 143'-0"  
Depth: 53'-6"  
Height: 29'-0"  
Foundation: Crawl Space





## LOVETT - PLAN M5062A3FD-0

### MAIN FLOOR



## LOVETT - PLAN M5062A3FD-0

### UPPER FLOOR



**LOVETT - PLAN M5062A3FD-0**

**THIRD FLOOR**

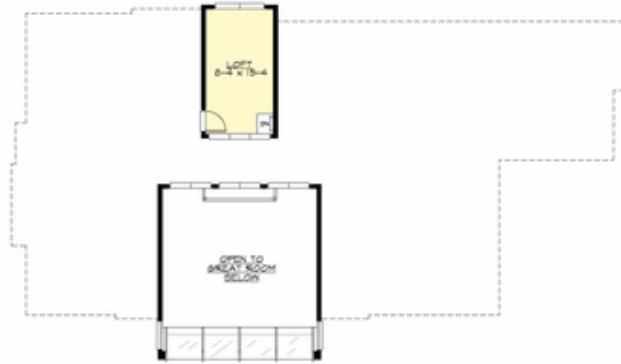



## LOVETT - PLAN M5062A3FD-0

### PLAN DETAILS

#### Area Summary

Total Area:	5062 sq. ft.
Main Floor:	2879 sq. ft.
Upper Floor:	2031 sq. ft.
3rd Floor:	152 sq. ft.
Garage Floor:	946 sq. ft.

#### General Information

Stories:	2
Width:	143'-0"
Depth:	53'-6"
Height:	29'-0"

#### Architectural Style

Contemporary  
Modern  
Prairie

#### Number of Rooms

Bedrooms:	3
Full Baths:	4
Half Baths:	1

#### Garage

Garage Size:	3
Garage Door Location:	Front
Garage Type:	Detached

#### Roof Pitches

Primary:	0:12
Secondary:	2:12

#### Wall Heights

Main:	10'-0"
Upper:	8'-0"
3rd Floor:	6'-0"
Lower:	0'-0"

#### Foundation Type

Crawl Space

#### Roof Framing

Stick

#### Floor Load

Live (lbs):	40 PSF
Dead (lbs):	10 PSF

#### Roof Load

Live (lbs):	25 PSF
Dead (lbs):	15 PSF
Wind:	85 MPH

#### Design Features

- Bonus Space @ Main Floor
- Den/Office
- Front Porch
- Great Room
- Laundry Room @ Main & Upper Floor
- Luxury Plan
- Master Bedroom @ Upper Floor Front
- View Lot - Front
- Wide Lot