



## KENNEDY - PLAN M5101A3S-0

Total Area: 5100 sq. ft.  
Garage Area: 944 sq. ft.  
Garage Area: 944 sq. ft.  
Garage Size: 3  
Stories: 2  
Bedrooms: 3  
Full Baths: 3  
Half Baths: 1  
Width: 62'-0"  
Depth: 96'-0"  
Height: 28'-0"  
Foundation: Crawl Space



## KENNEDY - PLAN M5101A3S-0

### MAIN FLOOR



**COPYRIGHT NOTICE:** It is illegal to build this plan without a legally obtained set of prints. It is illegal to copy or redraw these plans. Violation of U.S. Copyright Laws are punishable with fines up to \$150,000. After the purchase of plans, changes may be made by a qualified professional.



## KENNEDY - PLAN M5101A3S-0

### UPPER FLOOR



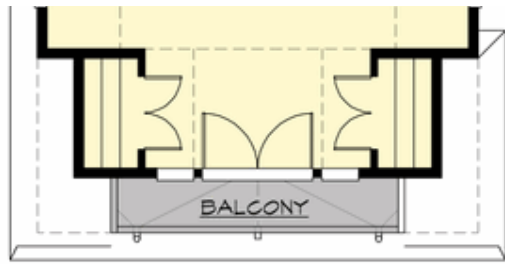



## KENNEDY - PLAN M5101A3S-0

### PLAN DETAILS

#### Area Summary

Total Area: 5100 sq. ft.  
Main Floor: 2392 sq. ft.  
Upper Floor: 2708 sq. ft.  
Garage Floor: 944 sq. ft.

#### General Information

Stories: 2  
Width: 62'-0"  
Depth: 96'-0"  
Height: 28'-0"

#### Architectural Style

Contemporary  
Farmhouse  
Modern

#### Number of Rooms

Bedrooms: 3  
Full Baths: 3  
Half Baths: 1

#### Garage

Garage Size: 3  
Garage Door Location: Side

#### Roof Pitches

Primary: 8:12  
Secondary: 4:12

#### Wall Heights

Main: 10'-0"  
Upper: 9'-0"

#### Foundation Type

Crawl Space

#### Roof Framing

Combination

#### Floor Load

Live (lbs): 40 PSF  
Dead (lbs): 10 PSF

#### Roof Load

Live (lbs): 25 PSF  
Dead (lbs): 15 PSF  
Wind: 85 MPH

#### Design Features

- Bonus Space @ Upper Floor
- Den/Office
- Front and Rear Porch
- Great Room
- Laundry Room @ Upper Floor
- Luxury Plan
- Master Bedroom @ Upper Floor Rear