



## TREASURE BARN - PLAN A1955A5FT-0

Total Area: 1955 sq. ft.  
Garage Area: 2065 sq. ft.  
Garage Area: 2065 sq. ft.  
Garage Size: 5+  
Stories: 2  
Bedrooms: 1  
Full Baths: 2  
Width: 81'-0"  
Depth: 47'-6"  
Height: 30'-0"  
Foundation: Slab On Grade



## TREASURE BARN - PLAN A1955A5FT-0

### MAIN FLOOR



## TREASURE BARN - PLAN A1955A5FT-0

### UPPER FLOOR

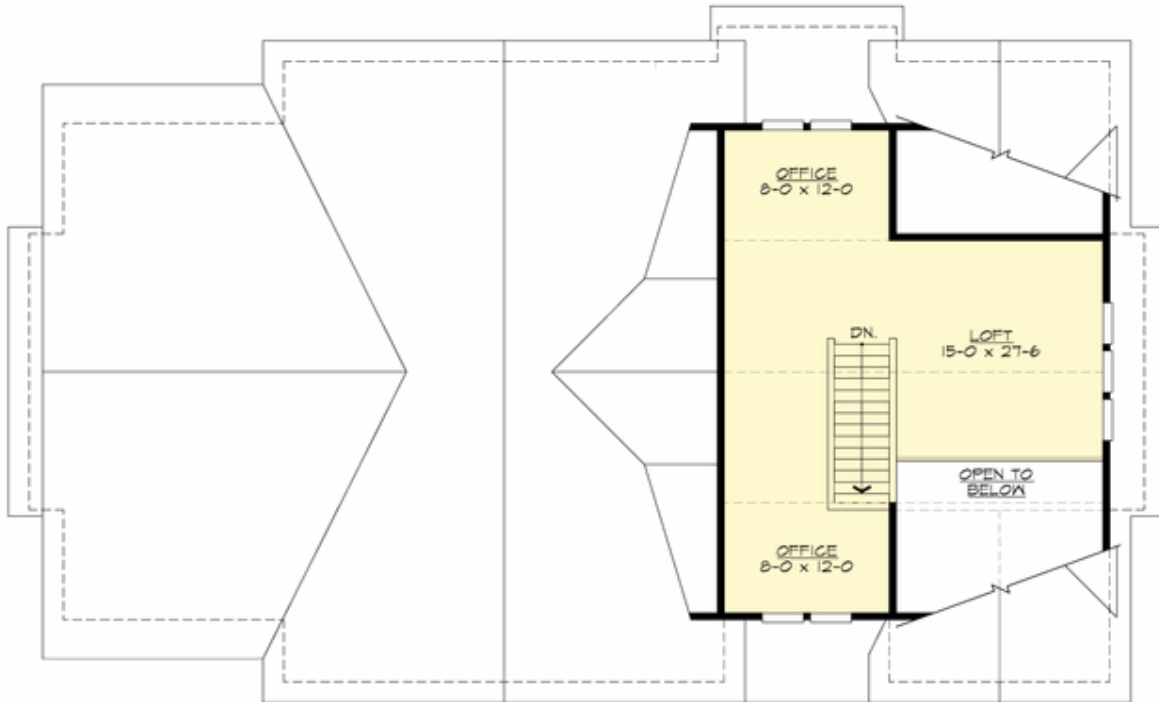



## TREASURE BARN - PLAN A1955A5FT-0

### PLAN DETAILS

#### Area Summary

Total Area: 1955 sq. ft.  
Main Floor: 1280 sq. ft.  
Upper Floor: 675 sq. ft.  
Garage Floor: 2065 sq. ft.

#### General Information

Stories: 2  
Width: 81'-0"  
Depth: 47'-6"  
Height: 30'-0"

#### Architectural Style

Country  
Farmhouse  
Modern

#### Number of Rooms

Bedrooms: 1  
Full Baths: 2

#### Garage

Garage Size: 5+  
Garage Door Location: Front  
Garage Type: Tandem

#### Roof Pitches

Primary: 10:12  
Secondary: 5:12

#### Wall Heights

Main: 9'-0"  
Upper: 8'-0"

#### Foundation Type

Slab On Grade

#### Roof Framing

Trusses

#### Floor Load

Live (lbs): 40 PSF  
Dead (lbs): 10 PSF

#### Roof Load

Live (lbs): 25 PSF  
Dead (lbs): 15 PSF  
Wind: 85 MPH

#### Design Features

- Bonus Space @ Upper Floor
- Great Room
- Laundry Room @ Main Floor
- Master Bedroom @ Main Floor Rear
- Small Plan
- Wide Lot