



CICERO - PLAN R3695A2S2ST-0DB

Total Area: 3695 sq. ft.
Garage Area: 1465 sq. ft.
Garage Area: 1465 sq. ft.
Garage Size: 4
Stories: 2
Bedrooms: 4
Full Baths: 2
Half Baths: 1
Width: 92'-6"
Depth: 94'-6"
Height: 18'-6"
Foundation: Daylight Basement



CICERO - PLAN R3695A2S2ST-0DB

MAIN FLOOR



CICERO - PLAN R3695A2S2ST-0DB

LOWER FLOOR

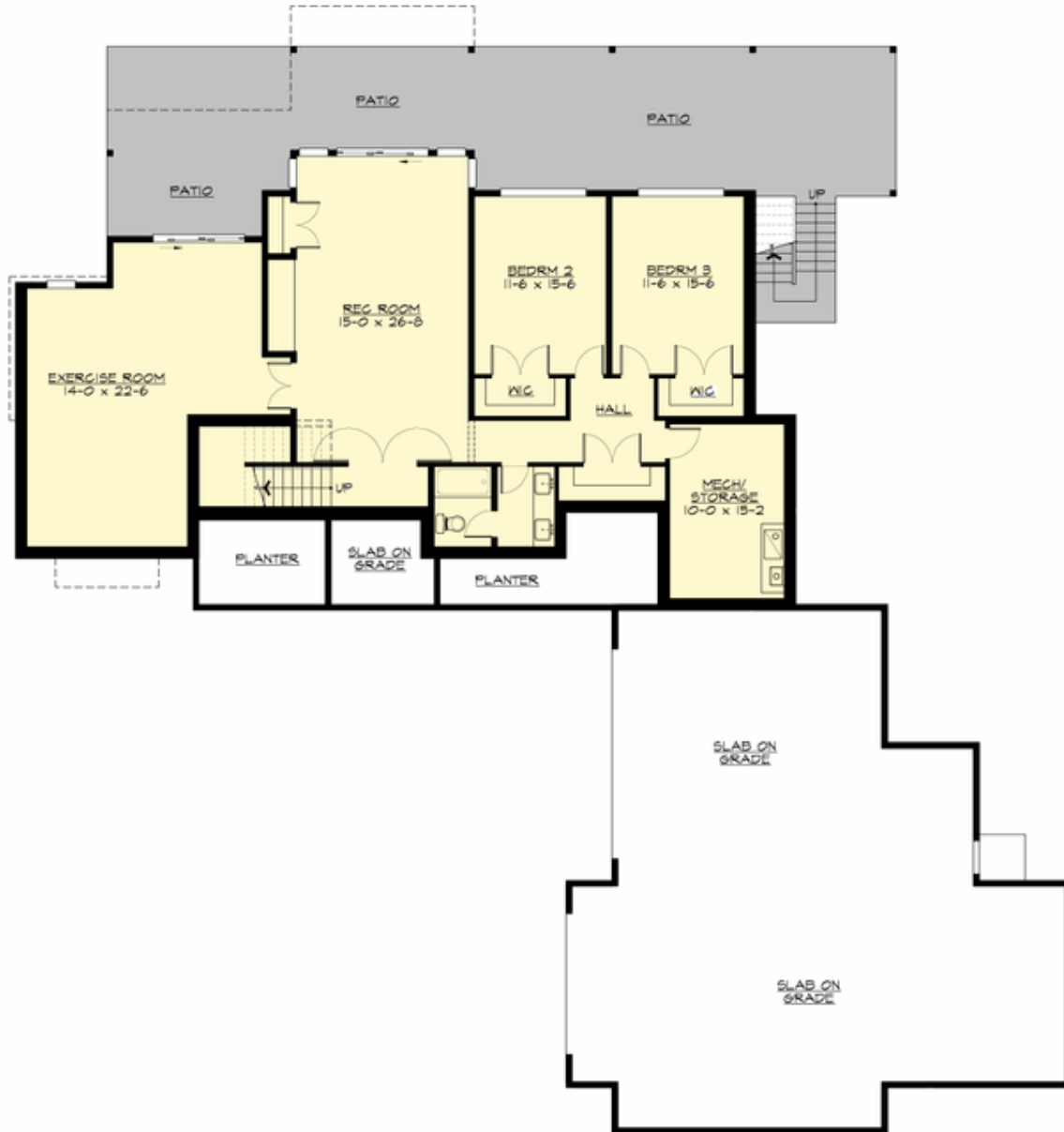



CICERO - PLAN R3695A2S2ST-0DB

PLAN DETAILS

Area Summary

Total Area: 3695 sq. ft.
Main Floor: 1999 sq. ft.
Lower Floor: 1696 sq. ft.
Garage Floor: 1465 sq. ft.

General Information

Stories: 2
Width: 92'-6"
Depth: 94'-6"
Height: 18'-6"

Architectural Style

Contemporary
Modern
Prarie

Number of Rooms

Bedrooms: 4
Full Baths: 2
Half Baths: 1

Garage

Garage Size: 4
Garage Door Location: Side
Garage Type: Tandem

Roof Pitches

Primary: 2:12

Wall Heights

Main: 10'-0"
Lower: 10'-0"

Foundation Type

Daylight Basement

Roof Framing

Stick

Floor Load

Live (lbs): 40 PSF
Dead (lbs): 10 PSF

Roof Load

Live (lbs): 25 PSF
Dead (lbs): 15 PSF
Wind: 85 MPH

Design Features

- Bonus Space @ Lower Floor
- Den/Office
- Great Room
- Laundry Room @ Main Floor
- Master Bedroom @ Main Floor Rear
- Rear Porch
- View Lot - Rear
- Wide Lot